

Elemento	Pos.	Diam.	Q.	Esquema (cm)	Comp. (cm)	Total (cm)	CA-50 (kg)	CA-60 (kg)
PN01=PN04=PN05 PN06	1	Ø10	4		155	620	3.8	
	2	Ø5	34		81	2754		4.3
	3	Ø10	4		318	1272	7.8	
	Total+10%: (x4):						12.8	4.7
PN02=PN03	1	Ø10	4		120	480	3.0	
	2	Ø5	34		81	2754		4.3
	3	Ø10	4		318	1272	7.8	
	Total+10%: (x2):						11.9	4.7
PN07=PN08	1	Ø10	4		120	480	3.0	
	2	Ø5	34		81	2754		4.3
	3	Ø10	4		318	1272	7.8	
	Total+10%: (x2):						11.9	4.7
PN10	1	Ø10	4		404	1616	10.0	
	2	Ø5	34		81	2754		4.3
Total+10%:						11.0	4.7	
PN09	1	Ø10	4		404	1616	10.0	
	2	Ø5	34		81	2754		4.3
Total+10%:						11.0	4.7	
PN11=PN12=PN13 PN14	1	Ø10	4		155	620	3.8	
	2	Ø5	34		81	2754		4.3
	3	Ø10	4		318	1272	7.8	
	Total+10%: (x4):						12.8	4.7
						Ø5:	0.0	65.8
						Ø10:	172.0	0.0
						Total:	172.0	65.8

Pilares que nascem em BALDRAME +11.64 e chegam em Cobertura +14.64
Concreto: C30, em geral
Aço das barras: CA-50 e CA-60
Aço dos estribos: CA-50 e CA-60

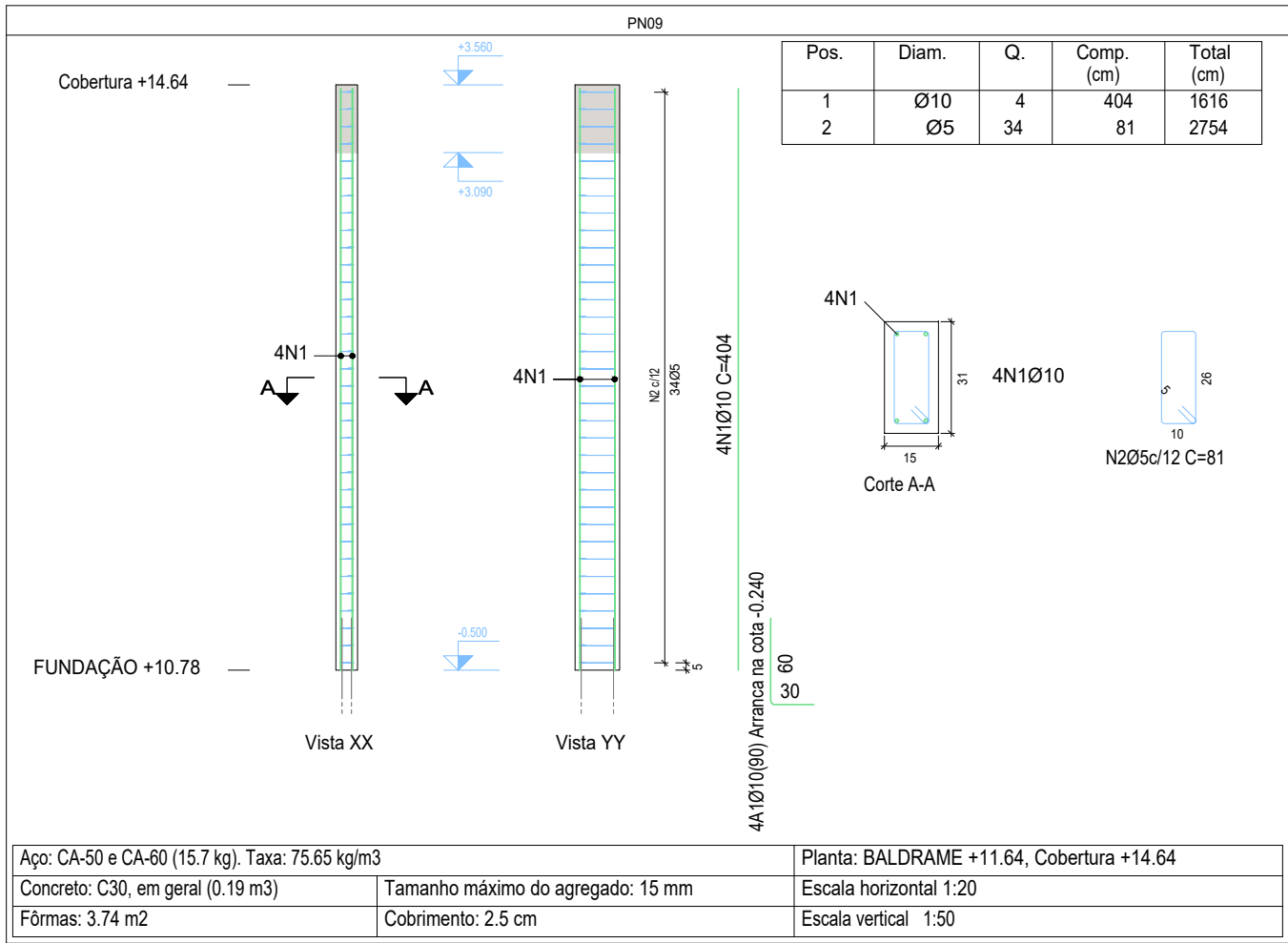

Resumo Aço Pilares	Comp. total (m)	Peso+10% (kg)	Total
CA-50 Ø8	39.0	17	
Ø10	438.8	297	314
CA-60 Ø5	643.1	111	111
Total			425

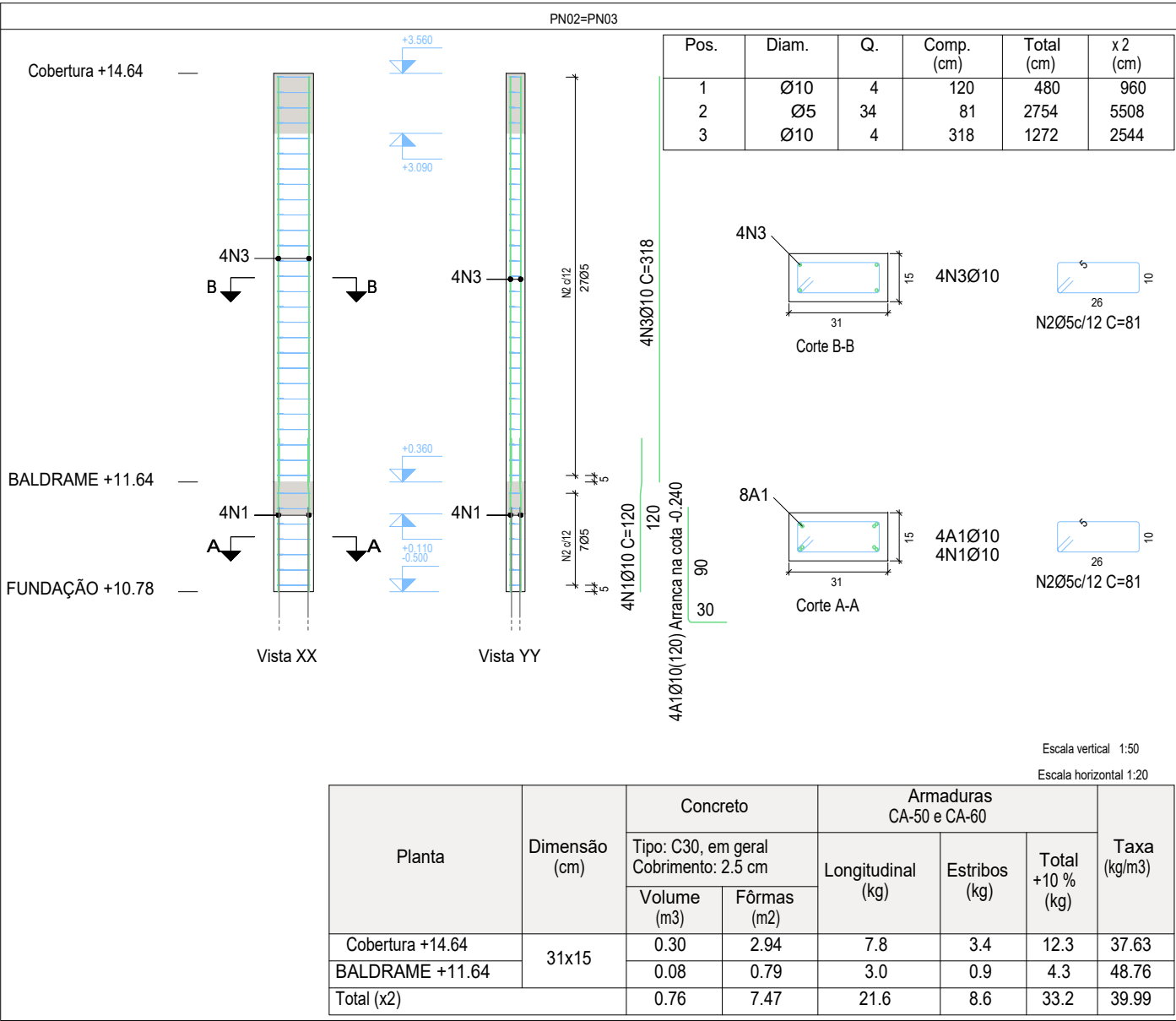